

4

3

2

1

REVISIONS				
ZONE	REV	DESCRIPTION	DATE	APPROVED

POWER REQUIREMENTS
 12 - 24 VAC or VDC
 12V MINIMUM
 24V MAXIMUM
 500mA MINIMUM
 RECOMMENDED

POSITIVE POWER LEADS
 INTERCONNECTED INTERNALLY;
 NEGATIVE POWER LEADS
 INTERCONNECTED INTERNALLY.

- AC/DC POSITIVE (+) POWER
- AC/DC POSITIVE (+) POWER
- AC/DC NEGATIVE (-) POWER
- AC/DC NEGATIVE (-) POWER
- GND
- RS232(TX) / RS485(TX-)
- RS232(RTS) / RS485(TX+)
- RS232(RX) / RS485(RX-)
- RS232(CTS) / RS485(RX+)

Aux Serial Port Internal Jumper Settings.
 Refer to Embedding Applications Programming document for more detail.

Mode	J15	J16	J17
RS-485 2-Wire Half Duplex *	1-2	1-2	1-2
Terminated (factory default)			
RS-485 2-Wire Half Duplex *	1-2	1-2	2-3
Not Terminated			
RS-422/RS-485 4-Wire	2-3	2-3	1-2
Terminated			
RS-422/RS-485 4-Wire	2-3	2-3	2-3
Not Terminated			
RS-232	2-3	2-3	2-3

* 2-Wire operation: RX- tied to TX- and RX+ tied to TX+ internally.
 Termination is 120 Ohms

- INPUT 1 (+)
- INPUT 2 (-)
- INPUT 3 (+)
- INPUT 4 (-)
- INPUT 5 (+)
- INPUT 6 (-)
- INPUT 7 (+)
- INPUT 8 (-)
- DIGITAL INPUT 1
- DIGITAL INPUT 2
- DIGITAL INPUT 3
- DIGITAL INPUT 4
- DIGITAL INPUT 5
- DIGITAL INPUT 6
- DIGITAL INPUT 7
- DIGITAL INPUT 8
- RELAY OUTPUT 1
- RELAY OUTPUT 2
- RELAY OUTPUT 3
- RELAY OUTPUT 4
- RELAY OUTPUT 5
- RELAY OUTPUT 6
- RELAY OUTPUT 7
- RELAY OUTPUT 8
- OUTPUT 1 - N/D CONTACT
- OUTPUT 2 - N/D CONTACT
- OUTPUT 3 - N/D CONTACT
- OUTPUT 4 - N/D CONTACT
- OUTPUT 5 - N/D CONTACT
- OUTPUT 6 - N/D CONTACT
- OUTPUT 7 - N/D CONTACT
- OUTPUT 8 - N/D CONTACT

RS232 COMMAND PORT
 3-WIRE COMMUNICATIONS 115,200 BAUD
 PIN 2 - TX (OUTPUT)
 PIN 3 - RX (INPUT)
 PIN 5 - GND

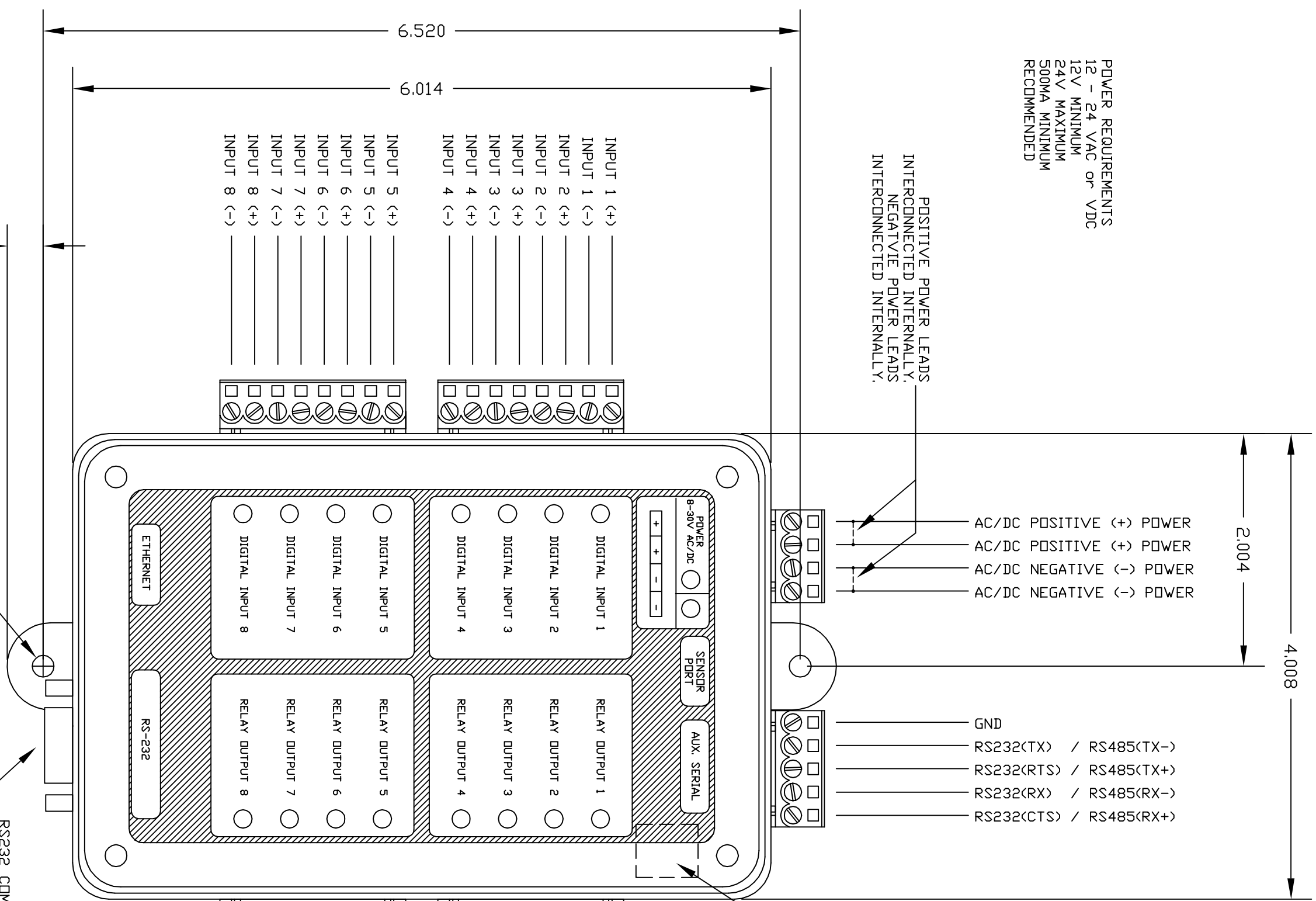
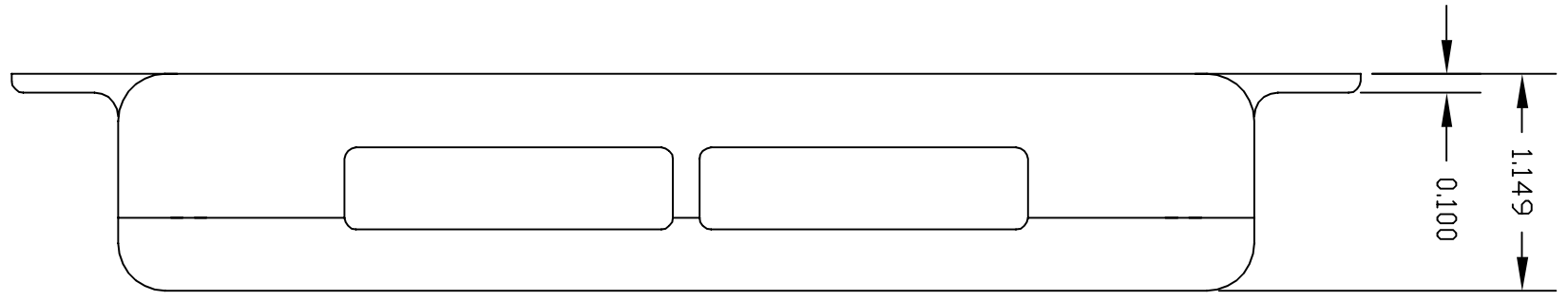

4

3

2

1

INTEG process group, inc (C) Copyright 2007, All Rights Reserved			
JNIDR Model 310 Connections & Mounting			
SIZE	FSCM NO.	DWG NO.	REV
C			--
SCALE	1:1	4/23/2007	SHEET 1 OF 1